



New England Vegetable and Fruit Conference

December 13 - 15, 2022

Double Tree by Hilton
Downtown Manchester, NH

Sponsored by

the Cooperative Extension Systems of:
Universities of Connecticut, Maine, Massachusetts,
New Hampshire, Rhode Island, Vermont, and Cornell University

Connecticut Agricultural Experiment Station

Maine Organic Farmers and Gardeners Association

New England Vegetable & Berry Growers' Association

Massachusetts Fruit Growers' Association

Conference at a Glance

TUESDAY Dec 13	8:00 AM	Trade Show 8:00 am - 6:00 pm Expo Center				
	9:30 AM to NOON	Sweet Corn Contoocook	Strawberry I Webster	Apples I Pemigewasset	Cut Flowers Armory	Equipment Merrimack/ Piscat.
	NOON to 1:45 PM	Extended Lunch: Network & Visit the Trade Show!	MFGA Annual Meeting 12:00-12:30 Pemigewasset	Farmer2Farmer Sessions 12:45-1:45 H2A/Labor - Frost/Hawthorne Equipment - Merrimack/Piscat. Cut Flowers - Contoocook		
	2:00 to 4:30 PM	Cucurbits Merrimack/ Piscat	Strawberry II Webster	Stone Fruit Pemigewasset	Organic Armory	Technology Contoocook
	4:30 to 6:00 PM	TRADE SHOW SOCIAL in the Expo Center	Farmer2Farmer Sessions 4:45-5:45 Strawberries: Organic - Merrimack/Piscat. Technology: Sensors, Cameras, Wi-Fi - Pemigewasset Gleaning/Food Security - Contoocook			
	6:00 to 9:00 PM	Worker Protection Standards Training Pemigewasset			Federal Income Taxes for Beginning Farmers 6:00-7:00 Contoocook	

Conference at a Glance

WEDNESDAY Dec 14	8:00 AM	Trade Show 8:00 am - 6:00 pm Expo Center				
	9:30 AM to NOON	Leafy Greens & Specialty Veg Merrimack/Piscat	Brambles Webster	Apples II Pemigewasset	Cover Crop/ No Till Armory	FSMA Contoocook
	NOON to 1:45 PM	Extended Lunch: Network & Visit the Trade Show!		Farmer2Farmer Sessions 12:45-1:45 Insect Management Updates - Pemigewasset Variety Updates Veggies A-Z - Merrimack/Piscat. Climate Change - Contoocook		
	2:00 to 4:30 PM	Brassicas/ Legumes Merrimack/Piscat	Specialty Berries Webster	Mushrooms Pemigewasset	Potatoes Armory	Food Safety Contoocook
	4:30 to 6:00 PM	TRADE SHOW in the Expo Center	Student Poster Session in Assembly Area (4:45 - 5:45)	Farmer2Farmer Sessions 4:45-5:45 Disease Mgmt Updates - Pemigewasset Washing Stations - Contoocook Greenhouse A-Z - Merrimack/Piscat.		
	6:00 to 7:30 PM	Social Mixer and Awards in Assembly Area				

THURSDAY Dec 15	8:00 AM	Trade Show 8:00 am - 2:00 pm Expo Center				
	9:30 AM to NOON	Tomatoes Merrimack/Piscat	Blueberry I Contoocook	Winter Growing Pemigewasset	Ag Tourism Frost/Howthorne	Grapes I Webster
	NOON to 1:45 PM	Extended Lunch: Network & Visit the Trade Show!		Farmer2Farmer Sessions 12:45-1:45 Winter Growing - Pemigewasset Tomatoes - Merrimack/Piscat. Marketing: Farmer Collaborative Models - Contoocook		
	2:00 to 4:30 PM	Alliums/ Roots Armory	Blueberry II Contoocook	High Tunnels Pemigewasset	Improving Farm Business Efficiency Merrimack/Piscat.	Grapes II Webster

Greetings and Welcome

Welcome to the 25th New England Vegetable and Fruit Conference and Trade Show. This meeting takes place every other year in December, and includes more than 30 educational sessions over 3 days. Topics include major vegetable, berry and tree fruit crops, and much more.

Farmer to Farmer meetings throughout the conference allow you to discuss specific issues in more detail. There is also an extensive Trade Show with over 120 exhibitors. We hope that you will enjoy your time here, and meet with fellow growers, advisors, researchers and industry representatives. We want you to leave with new ideas and information that will have a positive impact on your farm.

This conference is special because it is put together with close collaboration between growers and Extension from across the region. The steering committee gathers the best speakers from within our region and across the country to tell you about the latest innovations and advances in vegetable and fruit production. Almost every session includes both farmers and research or extension personnel, so you are getting the “best of both worlds.”

The New England Vegetable and Fruit Extension team also collaborates to conduct research, hold other educational programs, and to create resources for the benefit of growers. These include the New England Vegetable Management Guide, the New England Small Fruit Management Guide, and the New England Tree Fruit Management Guide which are published every other year. For more information about New England Vegetable and Fruit Extension Programs contact your state Extension office.

Our sponsors invite you to visit the Trade Show during the conference. We invite businesses and organizations to exhibit at the Trade Show for the purpose of providing information to the participants. While we make responsible efforts to assure the integrity of the exhibitors, the conference sponsors do not guarantee or warranty any product exhibited; neither do the sponsors imply approval of or endorse any product to the exclusion of others that may be available.

We value your feedback! We use your comments and suggestions to plan the next program. Please tell us what you think by filling out a paper or electronic evaluation.



Steering Committee

General Chair

Susan Scheufele, UMass

Program Chair

David T. Handley, UMaine

Publicity/Promotion

Olivia Saunders, UNH

Registration

Shuresh Ghimire, UCONN

Treasurer

Christopher Grant, NEVBGA

Trade Show Manager

Brian Aldrich, Crop Consultant

Local Arrangements

Olivia Saunders, UNH

Pesticide Recertification

Heather Bryant, UNH

Proceedings

Ann Hazelrigg, UVM

CCA/CEU Recertification

Mark Hutchinson, UMaine

Secretary

Elisabeth Hodgdon, Cornell

Farmer to Farmer

Sandy Arnold, Pleasant Valley Farm, NY

Media Specialist

Robert Arnold, Smart Farm Innovations, NY

Evaluations

Becky Sideman, UNH

Travel

Christopher Grant, NEVBGA

Local Foods Coordinator

Andre Cantelmo, Heron Pond Farm, NH

Members At-Large & Moderators

Sandy Arnold, Pleasant Valley Farm, NY

Michael Basedow, Cornell

Alby Brandon, Grower, RI

Heather Bryant, UNH

Chris Callahan, UVM

Ben Clark, MA Fruit Grower's Assoc.

Jon Clements, UMass

Jeremy Delisle, UNH

Rob Durgy, CT

Heather Faubert, URI

Caleb Goossen, MOFGA

Duane Greene, UMass

David T. Handley, UMaine

Trevor Hardy, NH

Ann Hazelrigg, UVM

Elisabeth Hodgdon, Cornell

Mark Hutton, UMaine

Tori Lee Jackson, UMaine

Scott Lewins, UVM

Jason Lilley, UMaine

Becky Maden, UVM

Lisa McKeag, UMass

Olivia Saunders, UNH

Susan Scheufele, UMass

Becky Sideman, UNH

Michaele Williams, Grower, CT



Pesticide Education Credits

Certified pesticide applicators from New England are eligible to receive pesticide applicator training (PAT) credits. Growers from New York are NOT eligible to receive PAT credits. Pick up a form during registration and complete the information on the top portion. Be sure to have your certification number with you. This form is to be used for the entire conference. To get credit for a session, you must attend the entire session and forms must be signed by the Session Moderator at the end of the session. Turn in both the pink and yellow copies of the form at the registration desk when you leave the conference and keep the white copy for your records.

Certified Crop Advisor: Continuing Education Units

Certified Crop Advisors who attend certain sessions are eligible to receive Continuing Education Units. A sign in/out sheet will be available for each session in the room. CCA members must SIGN IN at the beginning of each session and SIGN OUT at the end of the session. You must attend the entire session to receive credit. Be sure to include your CCA membership number.

Credits are awarded in topic areas. Credits are listed by topic area under the heading for each session. **Topic areas are: Nutrient Management, Soil & Water Management, IPM, Crop Management, and Professional Development.** Credits will be listed in that order (e.g., # nut, # s&w, # ipm, # crop, # pd) and also provided as a list in registration packets.

Farmer to Farmer Sessions

What are farmer to farmer sessions? They are informal “chat” sessions where farmers learn from farmers and other knowledgeable presenters. There will be very short or no presentations at these sessions. Farmers can brainstorm and talk about what works for them and what doesn't, while learning new ideas from all who attend these roundtable discussions.

Why should I attend? Much can be learned from a mixed group of farmers, presenters, Extension people, researchers, and other interested folks. It will allow you a chance to ask questions of presenters and also of those who have experience in farming.

Share your expertise! For any topic, bring photos, videos, a favorite tool, etc.

Student Poster Session

Students have been conducting relevant research that you might want to know about at one of our collaborating institutions. Check them out in the Assembly Area outside the Ballrooms! On **Wednesday evening** students will be on hand to present their posters - stop by and meet them!

Lunch

Each day of the conference, a selection of lunch offerings featuring local ingredients will be set up near the Trade Show exhibition hall and in the Assembly area outside of the ballrooms. In partnership with the Double Tree by Hilton Manchester Downtown, the New England Vegetable & Fruit Conference Steering Committee has made an effort to source locally grown ingredients. Lunch and refreshments will also be available at the hotel restaurant (to the left of the front desk), 'The Daily Brew' and at many restaurants nearby in downtown Manchester.

Social Mixer and Awards Program

On **Wednesday** evening, the Conference is sponsoring a social mixer and awards ceremony from 6:00 to 9:00 pm with cash bar and light refreshments. The purpose of this event is to bring everyone together including guests from various state Departments of Agriculture and the New England Land Grant Universities. There will be a short speaking program that will include a brief awards program for the New England Vegetable Berry Growers Association to honor outstanding contributors for local agriculture. The cost of this event is covered by the Conference and Industry supporters of local agriculture. All are invited to this free event. Dinner will be on your own.

Trade Show

The trade show features over 120 exhibitors, and is open from 8am-6pm on **Tuesday & Wednesday**, and from 8am-2pm on **Thursday**. On **Tuesday evening**, the trade show is sponsoring a social from 4:30-6pm. Light refreshments and non-alcoholic beverages will be provided. Come and visit our exhibitors!

NEVBGA

The New England Vegetable & Berry Growers Association (NEVBGA) is the oldest vegetable growers association in the United States. We support and promote the vegetable and berry industries in New England.

The Association is a co-sponsor of the New England Vegetable and Fruit Conference. Made up of farmers and research and Extension personnel from Universities and Industry, we provide educational programming, publications, and networking opportunities for growers of all scales and production practices. We also support University research projects relevant to New England growers. You are invited to become a member!

We are offering a REDUCED RATE on Association dues for
FIRST TIME MEMBERS attending the CONFERENCE!!
Visit us at our table by the registration booth.

Tuesday Morning

8:00

Trade Show Opens

	Sweet Corn Contoocook	Strawberry I Webster	Cut Flowers Armory
	<i>Credits</i> CCA: S&W 0.5 / IPM 1.5	<i>Credits</i> CCA: IPM 1 / PD 1	<i>Credits</i>
9:30	Panel: What Varieties are We Growing? Justin Gray, Pineland Farms, ME; Trevor Hardy, Brookdale Fruit Farm, NH	Strawberry Variety Update: Nursery Perspective Tim Nourse, Nourse Farms, MA	Cut Flower Production: 5 Commonly Made Mistakes to Avoid Grace Lam, Fivefork Farms, MA
10:00	Herbicide Mode of Action Review Lynn Sosnoskie, Cornell University, NY	Weed Management - Getting Started David Handley, University of ME	Overwintering Cut Flowers for Early Season Production in the Northeast Joy Longfellow, Johnny's Selected Seeds, ME
10:30	No-Till Grower Experience Trevor Hardy, Brookdale Fruit Farm, NH	Strawberry Herbicide Update Thierry Besacon, Rutgers University, NJ	Year Round Flower Farming and Winter Tulip Production Emily Von Trapp, Von Trapp Flowers & The Tulip Workshop, VT
11:00	Advances in Sweet Corn Bird Management Rebecca Brown, University of RI	A Strawberry Industry Snapshot Becky Sideman, University of NH	Cut Flowers and Finding the Right Scale at Understory Farm Jessie & Gregory Witscher, Understory Farm, VT
11:30	Sweet Corn IPM, What's New Kyle Quigley, University of NH	Strawberries at Brookdale Farm Trevor Hardy, Brookdale Fruit Farm, NH	Greens and Flowers Year Round for Profitable Production in Zone 4 of Vermont Cathy Wells, Unity Farm, VT

12:00 - 1:45 **Extended Lunch: Network • Visit the trade show • Fa**

Tuesday Morning

Trade Show Opens

Apples I Pemigewasset	Equipment Merrimack/Piscat
<p><i>Credits</i> CCA: IPM 1 / Crop 1</p>	<p><i>Credits</i> CCA: Crop 2</p>
<p>Use of the Seafood Byproduct Chitosan for Management of Apple Diseases in the Northeast Anissa Poleatewich, University of NH</p>	<p>Mechanical Harvesters Mark Fasching, Jericho Settlers, VT</p>
<p>Improved Monitoring and Management of Apple Maggot Fly Using Multi-cultivar Grafted Trees and a Novel Attract-and-Kill IPM Strategy. Dr. Jaime Piñero, University of MA Amherst</p>	<p>The Evolution of Cultivation on a Mixed Vegetable Farm Andre Cantelmo, Heron Pond Farm, NH</p>
<p>Nursery Production of Containerized (air root pruning) Trees; advantages/disadvantages Todd Einhorn, Michigan State University</p>	<p>Transplanter and Equipment Modifications for No-Till Veggies in Multi-year White Clover Lincoln Fishman, Sawyer Farm, MA</p>
<p>Apple Variety Grower Panel (1 hour) We're not just growing Macs and Cortlands! Giff Burnap, Butternut Farm, NH How much do apple varieties really matter? PYO vs. retail Chelcie Martin, Honey Pot Hill Orchards, MA</p>	<p>Equipment Innovations for Cover Cropping and Reduced Tillage Ben Dana, Root 5 Farm, VT</p>
<p>Love your fruit as much as we do! Bill & Rupert Suhr, Champlain Orchards, VT 21st Century Apples: MAIA & more! Win Cowgill, Win Enterprises Intl., LLC, NJ</p>	<p>Spreaders and Tools for Easy and Accurate Amendment Application Justin Rich, Burnt Rock Farm, VT</p>

Massachusetts Fruit Growers Annual Meeting to immediately follow this session.

• Farmer2Farmer Sessions

Tuesday Afternoon

12:00
-12:30 **Massachusetts Fruit Growers' Annual Meeting**
Pemigewasset

12:45
-1:45 **Farmer2Farmer:
H2A/Labor**
Frost/Hawthorne

**Farmer2Farmer:
Equipment**
Merrimack/Piscat

**Farmer2Farmer:
Cut Flowers**
Contoocook

Cucurbits
Merrimack/Piscat

Strawberry II
Webster

Organic
Armory

Credits
CCA: IPM 1 / Crop 1

Credits
CCA: IPM 1 / Crop 1

*Credits CCA: Nut 0.5 /
S&W 0.5 / IPM 1*

2:00 **Everything You Need to
Know to Effectively Man-
age Cucurbit Diseases**
Meg McGrath, Cornell
University, NY

**Matted Row Renovation
Step By Step**
David Handley, University
of ME

**Managing Nitrogen in
Organic Systems**
Bruce Hoskins, Universi-
ty of ME

2:30 **Managing Downy Mildew
with Resistant Cuke
Varieties**
Susan Scheufele, Universi-
ty of MA

**Growing Strawberries in
Substrate**
Tim Elkner, Penn State
University

**Get the Best from
Biopesticides: modes
of action and how they
impact success**
Amara Dunn, Cornell
University, NY

2:45
3:00 **Reduced Tillage Cucur-
bit Production: positive
effects on soil health and
fruit quality but what are
the stumbling blocks?**
Jim Ward, Ward's Berry
Farm, MA

**Soil Insects: ID and Man-
agement**
Richard Cowles, Connecti-
cut Agricultural Experi-
ment Station

**Biofungicides for
Brassica Alternaria
Management - a new
hope?**
Ethan Grundberg, Cornell
University, NY

3:15
3:30 **A Primer on High Tunnel
Cucumber Production**
Laura Ingwell, Purdue
University, IN

**Strawberry Anthracnose
Issues**
Tim Elkner, Penn State
University

**Panel: To till or not: vary-
ing approaches to tillage
reduction on diversified
market farms**
Amanda Andrews, Tama-
rack Hollow Farm, VT; Nick
Whatley, Whatley Farm,
ME; Lincoln Fishman, Saw-
yer Farm, MA

4:00 **Growing Summer
Cucurbits at Edgewater
Farm**
Ray Sprague, Edgewater
Farm, NH

**The Hard and
Lonely Decisions of a
Strawberry Grower**
John Shenk, Shenk's Berry
Farm, PA

Tuesday Afternoon

Stone Fruit Pemigewasset

Credits
CCA: IPM 1.5 / Crop 1

Growing Peaches in a Cold Climate
Renaë Moran, University of ME

Insect Pest Management of Stone Fruit in the Hudson Valley of NYS
Peter Jentsch, Poma Tech, NY

Why it's time for a new peach production system
Jim Schupp, Penn State Fruit Research and Education Center

Accede for Thinning Peaches
Jim Schupp, Penn State Fruit Research and Education Center

Stone Fruit Disease Control: the New Jersey perspective
Win Cowgill, Win Enterprises Intl., LLC, NJ

Technology Contoocook

Credits
CCA: S&W 1 / PD 1

New Developments: small to large scale irrigation automation
Anthony Tasselli, Toro, NC

Soil Moisture is Money-in-the-Bank
Manuel Diaz, USDA-NRCS, MA

Cheap Insurance: Farm Monitoring Sensors
Jack Mannix, Walker Farm, VT

Simpler and More Powerful Record-Keeping: Airtable for Farms
Julian Post, 3 Rings Consulting, NY

Keeping Track of Your Farm: Camera Systems
Michael Kilpatrick, Farm on Central, OH

Tuesday Afternoon/Evening

4:30
-6:00

Trade Show Social **Expo Center**

Light refreshments will be provided.

4:45
-5:45

Farmer2Farmer: **Strawberries - Organic** **Merrimack/Piscat**

Farmer2Farmer: **Gleaning / Food Security** **Contoocook**

6:00
-7:00

Don't Fear the Schedule F! **Basic Federal Income Taxes for New Farmers**

Mike Sciabarrasi

Contoocook

Mike is a retired ag business extension specialist from UNH. This session will train beginner farmers how to do their taxes.

6:00
-9:00

Worker Protection Standards Training

Andrea Szylvain, EPA

Pemigewasset

EPA's revised Worker Protection Standard (WPS) requires those who conduct pesticide safety training for farmworkers and pesticide handlers to meet certain qualifications. One way to qualify as a WPS pesticide safety trainer is to complete an EPA-approved Train-the-Trainer program. Those completing the session will receive a certificate that documents course completion, and are able to train agricultural workers and handlers. EPA approved materials will be used. PAT credits will also be available.

Farmer2Farmer:
Technology: Sensors, Cameras, Wi-Fi
Pemigewasset



Wednesday Morning

8:00

Trade Show Opens

	Leafy Greens Merrimack/Piscat	Brambles Webster	Apples II Pemigewasset
	<i>Credits</i> CCA: Crop 2	<i>Credits</i> CCA: IPM 0.5 / Crop 2	<i>Credits</i> CCA: S&W 0.5 / IPM 1 / Crop 1
9:30	Beyond Bok Choy: growing and marketing Asian vegetables Larry Tse, Dig Inn Farm, NY; Christina Chan, Choy Division Farm, NY	High Tunnel Raspberries at Four Corners Farm Charlie Gray, Four Corners Farm, VT	Preemergent Herbicides Lynn Sosnoskie, Cornell University, NY
10:00	Asparagus Production at Fairwinds Farm Cathy Karonis and Charlie Rackley, Fairwinds Farm, ME	The Raspberry Plant: What You Should Know David Handley, University of ME	Perennial Weeds and Weed Control Lynn Sosnoskie, Cornell University, NY
10:30	Specialty Crop Research Updates: growing artichokes and radicchio in the Northeast Mark Hutton and Peyton Ginakes, University of ME	Long Cane Raspberry Substrate Culture Erica Pate, OMAFRA, Canada	Soil Moisture Readings: what they mean and how to interpret them to make irrigation decisions Manual Diaz, USDA-NRCS, MA
11:00	Celery Production for Profit Paul Arnold, Pleasant Valley Farm, NY	Raspberry & Blackberry Variety Performance in Connecticut Mary Conklin, University of CT	Orchard Economics Terence Bradshaw, University of VT
11:30	Specialty Crop Production and Lettuce Succession Planting at Siena Farms Mike Sushchik and Mishreky Lawandy, Siena Farms, MA	Spotted Wing Drosophila and other Raspberry Insect Problems David Handley, University of ME	A Multipronged Approach to Crop Load Management in Apples Todd Einhorn, Michigan State University

12:00 - 1:45 **Extended Lunch: Network • Visit the trade show • Fa**

Wednesday Morning

Trade Show Opens

Cover Crop/No Till Armory

Credits
CCA: S&W 1.5 / IPM 0.5

Cut and Carry Cover Crops
Spencer Blackwell, Elmer Farm, VT

Planting Cover Crops for Pollinator Habitat
Laura Johnson, University of VT

Building up Sandy Soils with Cover Crops
Ben Dana, Root 5 Farm, VT

Covering Ground: interseeded cover crops in late season vegetables
Gladys Asieduwaa, University of ME

Getting the Most Cash Out of Your Cover Crops
Charlie Gray, Four Corners Farm, VT

FSMA Contoocook

Credits
CCA: S&W 1 / PD 1.5

Regulatory Update
Lisa McKeag, University of MA; Heather Bryant, University of NH

Overlooked Risks in Water Systems: lessons learned from inspections
Tucker Diego, VT Agency of Agriculture

Harvest Farm's Product Traceability Program
Gary Gemme, Harvest Farm, MA

The Jumpstart to Farm Food Safety Program: Farming is hard work; we help with the food safety parts
Mary Saucier Choate, University of NH

Pre-harvest Water System Cleaning
Robert Hadad, Cornell University, NY

• Farmer2Farmer Sessions

Wednesday Afternoon

12:45
-1:45

**Farmer2Farmer:
Insect Management Updates**
Pemigewasset

**Farmer2Farmer:
Climate Change**
Contoocook

Brassicas & Legumes
Merrimack/Piscat

Specialty Fruit
Webster

Mushrooms
Pemigewasset

Credits
CCA: IPM 0.5 / Crop 1.5

Credits
CCA: Crop 1 / PD 1.5

Credits
CCA: PD 2.5

2:00

Advances in Broccoli Varieties
Thomas Bjorkman, Cornell University, NY

10 years of growing honeyberries in central New Hampshire
Ben Shambaugh, Wayside Farm, NH

Culinary and Medicinal Mushrooms: eat them, grow them, tell all your friends!
Tina Ellor, Phillips Mushroom Farms, PA

2:30

Overcoming the Challenges of Cauliflower Production
Jan van de Heide, Bejo, NY

An update on kiwiberries in New England
Iago Hale, University of NH

Outdoor Mushroom Cultivation: making marginal land profitable
Courtney Williams, Marr Pond Farm, ME

3:00

Managing Brassica Foliar Disease
Cristy Hoepting, Cornell University, NY

Growing Kiwiberries in New England: a grower's perspective
Lars Demander, Clover Nook Farm, CT

Adding Mushroom Production to Your Horticultural Operation
Erik Schellenberg, Cornell University, NY

3:30

Wholesale Green Bean: how we do it
Justin Gray, Pineland Farms, ME

Elderberry Opportunities
David Handley and Tori Jackson, University of ME

How to Produce Year-round, High-end Mushrooms for Direct Market
Eric Milligan, New Hampshire Mushroom Company

4:00

Snap Peas: a successful high tunnel alternative
Sue Decker, Blue Star Farm, NY

Small Scale Processing Opportunities
Amanda Kinchla, University of MA

Mushrooms Need Food Safety, Too!
Mary Saucier Choate, University of NH

Wednesday Afternoon

Farmer2Farmer: Variety Updates Veggies A-Z Merrimack/Piscat

Potatoes Armory	Post Harvest Contoocook
<p><i>Credits</i> CCA: IPM 1 / Crop 1.5</p>	<p><i>Credits</i> CCA: PD 2</p>
<p>Colorado Potato Beetle Management: problems, solutions and perspectives Andrei Alyohkin, University of ME</p>	<p>PFAS Contamination and Vegetable Farming Caleb Goosen, MOFGA, ME</p>
<p>Cultural Practices to Optimize Crop Quality and Potential Bob Chapelle, Chappelle's Potatoes, VT</p>	<p>Lessons from a PFAS Impacted Maine Farm Adam Nordell and Johanna Davis, Songbird Farm, ME</p>
<p>Managing Potato Diseases, from Seed to Field Beth Gugino, Penn State University</p>	<p>Farmer Panel: case study (1 hour) Moderator Chris Callahan, University of VT</p> <p>Building from the Ground Up: new construction of a pack shed Phoenix & Megan O'Brien, Hall Brook Farm, ME</p> <p>Giving a Dairy Barn New Life: renovating a bank barn as a pack shed Elizabeth Keen, Indian Line Farm, MA</p> <p>Working with an Open Plan: three season pack shed with prefab steel trusses Kate Donald, Stout Oak Farm, NH</p>
<p>Designing On-Farm Potato Variety Trials for Disease and Insect Resistance Brett Johnson, University of ME</p>	<p>Working with an Open Plan: three season pack shed with prefab steel trusses Kate Donald, Stout Oak Farm, NH</p>
<p>Postharvest Systems for Small- and Medium-scale Wholesale Potato Production Justin Rich, Burnt Rock Farm, VT</p>	<p>State Funded Produce Safety Improvement Programs (30 min) Michael Botelho, MA Dept of Ag Resources; Kim Burns, VT Agency of Ag, Food and Markets; Chris Callahan, University of VT</p>

Wednesday Afternoon/Evening

4:45
-5:45

**Farmer2Farmer:
Disease
Management
Updates**
Pemigewasset

**Farmer2Farmer:
Washing Stations**
Contoocook

**Farmer2Farmer:
Greenhouse A-Z**
Merrimack/Piscat

6:00
-7:30

Social Mixer and Awards Ceremony Assembly

The Conference sponsors a social mixer and awards ceremony with cash bar and light refreshments. The purpose of this event is to bring everyone together including guests from various state Departments of Agriculture and the New England Land Grant Universities. There will be a short speaking program that will include a brief awards program for the New England Vegetable Berry Growers Association to honor outstanding contributors for local agriculture. The cost of this event is covered by the Conference and Industry supporters of local agriculture. All are invited to this free event.



Wednesday Afternoon/Evening

Student Poster Session Assembly

We've introduced a poster session for students who have been conducting relevant research that you might want to know about at one of our collaborating institutions. Check them out in the Assembly Area outside the Ballrooms!



Thursday Morning

8:00

Trade Show Opens

	Tomatoes Merrimack/Piscat	Blueberry I Contoocook	Winter Growing Pemigewasset
	<i>Credits</i> CCA: Nut 0.5 / S&W 0.5 / Crop 1.5	<i>Credits</i> CCA: S&W 0.5 / IPM 1.5	<i>Credits</i> CCA: IPM 1 / Crop 1
9:30	The Race to be First with Early Season Tomatoes and Our Approach to IPM and Soil Management Brett McKenzie, McKenzie's Farm, NH	Getting Ready for the 2023 Blueberry Season Ben Waterman, Waterman Orchards, VT	The Ins and Outs of Growing Overwintered/Spring Alliums—Onions, Scallions and Garlic Michael Kilpatrick, Farm on Central, OH
10:00	Tomato Variety Trends Pete Zuck, Johnny's Selected Seeds, ME	Managing Water and Fertility for Best Results in Highbush Blueberry Plantings Laura McDermott, Cornell University, NY	Soil Steaming Research Updates: weed & disease management Becky Maden, UVM Extension/Singing Cedars Farmstead, VT; Andrew Cantelmo, Heron Pond Farm, NH
10:30	Heat Stress and Physiological Disorders of Tomatoes Jerry Brust, University of MD	Research Update on Managing Spotted Wing Drosophila Greg Loeb, Cornell University, NY	Insect and Disease Updates in Winter Production Ann Hazelrigg, University of VT; Anna Wallingford, University of NH
11:00	Growing Tomatoes Outdoors for Processing Tim Wilcox, Kitchen Garden Farm, MA	Wild (lowbush) Blueberry Production Lily Calderwood, University of ME	Climate Battery Geothermal High Tunnel Update David Greenberg, Abundant Acres Farm, Nova Scotia, Canada
11:30	Starting from the Ground Up: building tunnel fertility for tomato crops Becky Maden, University of VT	Lasar Scarecrows: a 21st century approach to bird control in Agriculture Rebecca Brown, University of RI Netting, Bird Calls, Laser Scarecrow: pros and cons in our 5 fields Sandra Barden, Barden Family Farm, RI	PacMan Style of Growing Winter Greens in Tunnels in Michigan for High Yields and Profit Brian Bates, Bear Creek Farm, MI

12:00 - 1:45 **Extended Lunch: Network • Visit the trade show • Fa**

Thursday Morning

Trade Show Opens

Ag Tourism & Marketing Frost/Hawthorne

Grapes I Webster

Credits

Credits

CCA: IPM 0.5 / Crop 1.5

Rethinking Your Marketing Messages to Broaden your Customer Base: findings from a survey of New England consumers
Analena Bruce, University of NH

"Natural" Wine and Viticulture: grower perceptions and practices

Terry Bradshaw and Bethany Pelletier, University of VT

Building Community with Farm Events

Brian Erickson and Frank Haferland, Stone Tree Farm & Cidery, ME; Christopher Piana, Fable Farm, VT

Perspectives on Natural and Biodynamic Wines: Grower Panel

Kendra Knapik, Ellison Estate Vineyard, VT; Nico Kimberly, NOK Vino and Shara Vineyards, NH; Kathline Chery, Kalche Wine Cooperative, VT

How Gleaning Can Fit Into Your Operation

Tim Taylor, Crossroads Farm, VT; Mikey Van Siclen, Willing Hands, VT

10:45

Grape Variety Update

Andy Farmer, Northeast Vine Supply, VT

Integrating CSA Platforms into the Overall Farm Marketing Program

Bethany Allen, Harvest Tide Organics, ME

11:15

Weed Control Strategies in the Vineyard

CJ Buzzy, Shelburne Vineyard, VT; Will Hastings, University of NH; Elijah Shields, Flag Hill Winery, NH

• **Farmer2Farmer Sessions**

Thursday Afternoon

12:45
-1:45

**Farmer2Farmer:
Winter Growing**
Pemigewasset

**Farmer2Farmer:
Tomatoes**
Merrimack/Piscat

2:00

Trade Show Closes: Last chance to visit exhibitors!

Alliums & Roots
Armory

Blueberry II
Contoocook

High Tunnels
Pemigewasset

Credits

CCA: IPM 1 / Crop 1.5

Credits

CCA: IPM 1 / Crop 1

Credits

CCA: Nut 0.5 / Crop 2

2:00

Cover Crop Considerations Prior to and Following Root Crops
Thomas Bjorkman; Cornell University, NY

Extending the Season with Frozen Fruit Products
Amanda Kinchla and Jill Fitzsimmons, University of MA

Winter Cover Crop in High Tunnels: home grown fertilizer and soil health
Judson Reid, Cornell University, NY

2:30

Disease Management Allium
Beth Gugino, Penn State University

Beyond Hand Harvesting of Highbush Blueberries
Sam Erwin, Indiana Berry & Plant Company, IN

How to Increase Fruit Set and Yield in High Tunnel Tomatoes
Jerry Brust, University of MD

3:00

Organic and Conventional Strategies to Limit Losses from Allium Insect Pests
Cristy Hoepting, Cornell University, NY

Blueberry Weed Management
Thierry Besancon, Rutgers University, NJ

Fitting It All In: moveable tunnels and more at Siena Farms
Mishreky Lawandy, Siena Farms, MA

3:30

What's New in Parsnips
Mark Hutton, University of ME

Emerging and Secondary Pests of Highbush Blueberry Production
Philip Fanning, University of ME

Using Structures to Increase Production Year-round
Adam Hainer, Juniper Hill Farms, NY

4:00

Root Crop Harvest: how we do it
Phoenix O'Brien, Hall Brook Farm, ME

Strategies for Growing Organic Blueberries at Adam's Berry Farm
Adam Hausman, Adam's Berry Farm, VT

High Tunnel and Greenhouse Ventilation: challenges, practices and trends
Chris Callahan, University of VT

Thursday Afternoon

Farmer2Farmer: Marketing—Farmer Collaborative Models Contoocook

Improving Farm Business Merrimack/Piscat

Credits
CCA: PD 2

Database and Software Management Tools to Help Your Farm Grow
Taylor Mendell, Footprint Farm, VT

Using a Whole Farm Planning Approach to Achieve Work/Life Balance and Long Term Goals
Olivia Saunders, Seth Wilner, Jeremy Delisle and Elaina Enzien, University of NH

The Farm and Ranch Stress Assistance Network and How You Can Tap Into Resources
Leslie Forstadt, University of ME

Changing Business Models for Maine Wild Blueberries
Lily Calderwood, University of ME

Succession Planning, Lessons Learned
Seth Wilner, University of NH

Grapes II Webster

Credits
CCA: IPM 2.5

Trunk Diseases
Elsa Petit, University of MA

Spotted Lantern Fly Update
Elizabeth Barnes, MA Department of Ag Resources

Biopesticides in the Vineyard
Dave Combs, Cornell University, NY

Developing a Basic Spray Program that Works
Terry Bradshaw, University of VT

UV Light to Manage Vineyard Diseases
David Gadoury, Cornell University, NY

DoubleTree by Hilton Downtown Manchester New Hampshire MAIN LEVEL

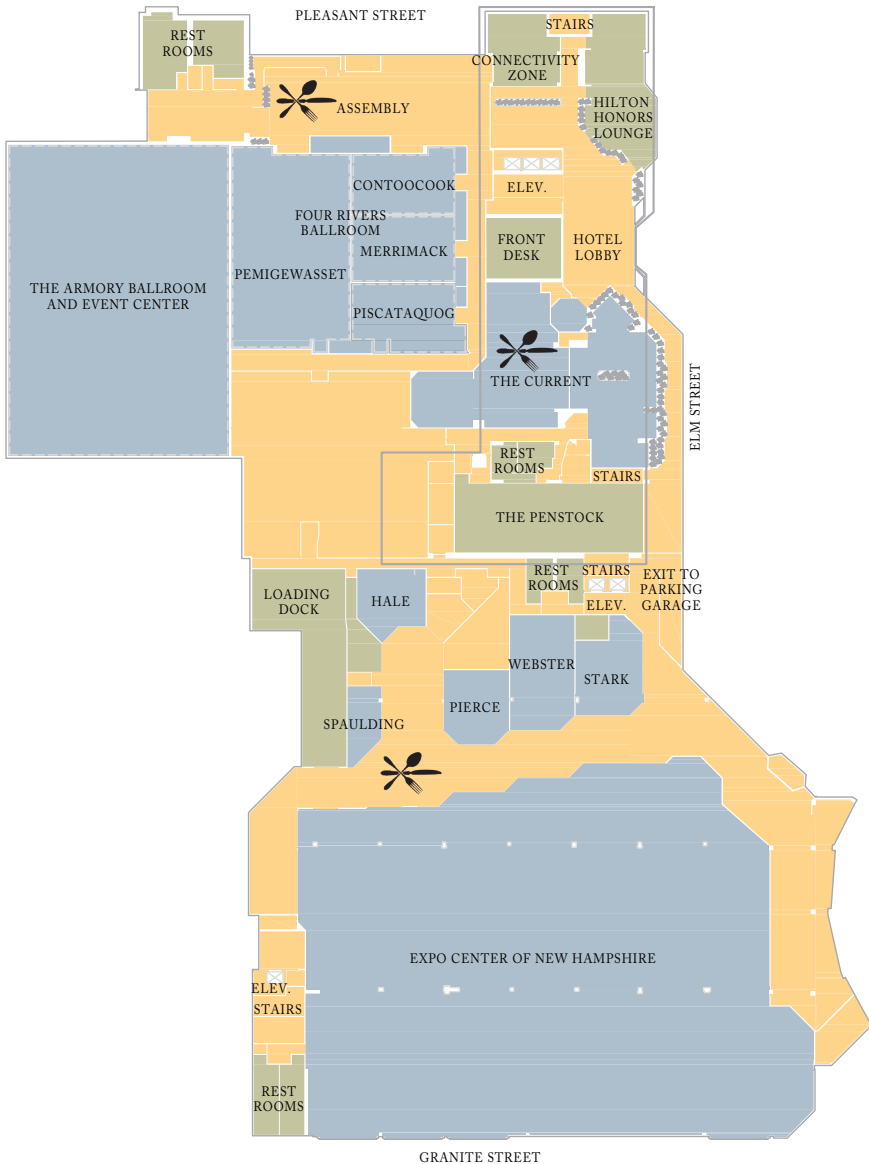

DoubleTree by Hilton Downtown Manchester New Hampshire SECOND FLOOR

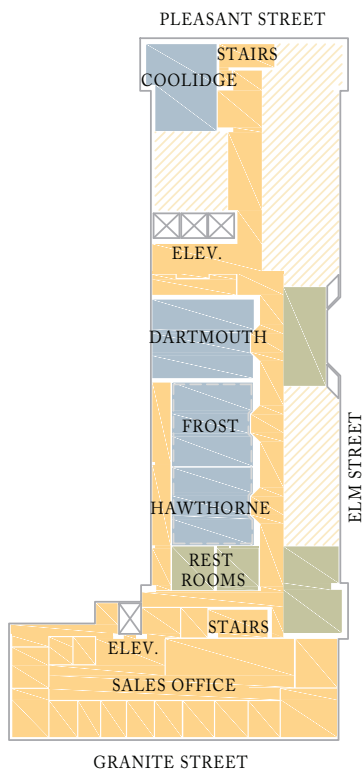

Lunch Options

Cafeteria-style lunch outside the trade show and in Assembly area; The Current offers sit-down service.

Trade Show Exhibitors

Adams County Nursery Inc.

Arthur Carroll Insurance Agency

Bakie Farm Initiative

Baystate Organic Certifiers

Boston Food Hub

Brookdale Farm Supplies

C+M (Checchi & Magli)
Transplanters

CaroVail

Certified Naturally Grown

Certis Biologicals

Charles W. Harris Co. Inc.

Connecticut Dept. of Agriculture

Connecticut Geenhouse

Country Folks Grower

Dubois Agrinovation Inc.

Farm Credit East, ACA

Farmers Choice Food Brands, Inc.

Fedco Seeds Inc.

FilmOrganic

FMC

Forigo Roter Italia

Frazer Insurance Agency, Inc.

Frost Farm Service Inc.

Gowan Seed Company

Gowan USA

Great Lakes IPM

Griffin Farm Equipment

GrownBy

Harris Seeds

Helena

High Mowing Organic Seeds

Hillside Cultivator Co. LLC

J.S. Woodhouse Co., Inc.

Johnny's Selected Seeds

Kifco

Kreher Enterprise LLC

Kult Kress LLC

LaGasse Machine & Fabrication, Inc.

Land for Good

MA Dept. of Agricultural Resources

Monosem

Monte Package Company

Trade Show Exhibitors

**NCAT/ATTRA Sustainable
Agriculture**

Netafim

NE Apple Association

NE Seed Co.

**New Hampshire Agricultural
Experiment Station**

Nine Pine Ciderworks LLC

Northeast Nursery, Inc.

**Northeast Organic Farming
Association**

Nourse Farms, Inc.

Nutrien Ag Solutions

OESCO, Inc.

OMEX USA

Packaging Corporation of America

Progressive Grower Inc.

Provide Agro Corporation

Radical Plastics

Rimol Greenhouse Systems

Rinieri

Risk Management Agency

River Valley Fencing

Rupp Seeds

Shawnee Canning Company Inc.

Smart Farm Innovations, LLC

Soletrac

SSR Equipment, Inc.

Tek-Knit Industries

Tew Mfg Corp

Texpak

The Rite Package Company, LLC

Tilmor

Toro Micro-Irrigation

United Ag & Turf

USDA Farm Service Agency - NH

**USDA Natural Resources
Conservation Service**

Valent USA

Vermont Compost Company

Vestaron Corp.

Wafler Nursery

Wellscroft Fence Systems, LLC



Cooperative Extension provides information and education to all people without regard to sex, race, color, national origin or disability.

Cooperative Extension is an equal opportunity employer.

newenglandvfc.org